

1 Curtain Details

Slat 2.32 in. [59mm] Extruded Aluminum Slat Perforated
0.20in. [5mm] Square

Color Options

 Clear Anodized

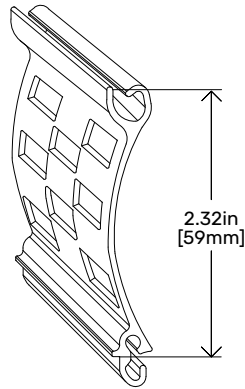

2 Bottom Bar

Bottom Bar

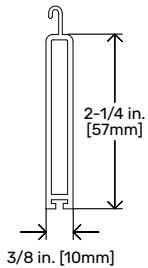

HD Bottom Bar (Optional)

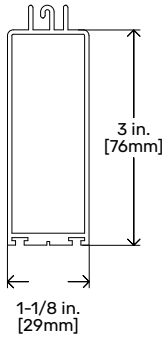

3 Guide Options

Guide Rail

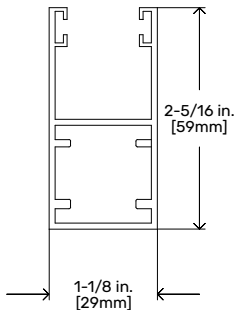

HD Guide Rail (Optional)

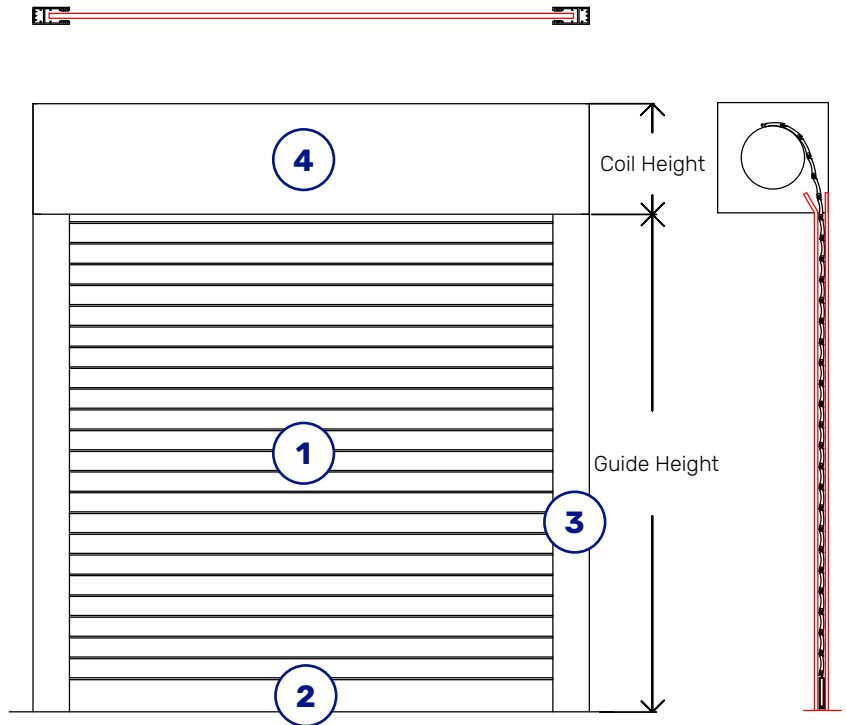
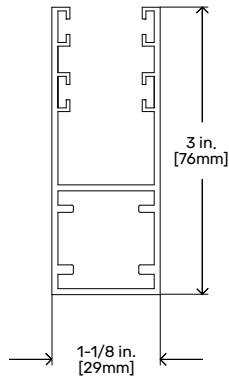

4 Coil Box Size

Coil Height	Guide Height
7 in. [178mm]	48 in. [1219mm]
8 in. [203mm]	76 in. [1940mm]
9 in. [229mm]	113 in. [2870mm]
10 in. [254mm]	160 in. [4064mm]

Features And Options

Mounting Type

Between Jamb

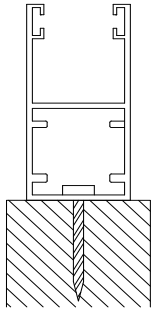

Face Of Wall

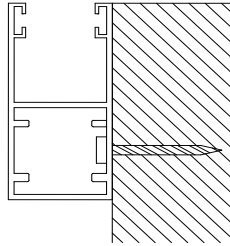

Locking Bottom Bar Options

- Locking Coil side or Opposite Coil with Slide Lock or Cylinder.
- Heavy Duty Bottom Bar with Standard Mortise, SFIC, LFIC or Thumbturn



LFIC



SFIC



StdMortise



Thumbturn



Standard Mortise Cylinder Key Switch

Operation

Manual Push/Pull

- Counterbalance with Spring Assist for easy manual operation
- Available with locking bottom Bar (Slide lock or Cylinder Locks)

Crank Operation

- Crank Operation Coil Side or Thru-Wall
- Available with locking bottom Bar (Slide lock or Cylinder Locks)

Electric Operation

- 120V In Tube Electric Motor Operation
- Push Button or Key Cylinder Switch for easy up/down

Motor Options

- Key Switch – Open/Close using Standard Mortise, SFIC
- RTS – Wireless Open/Close using Telis remote
- Crank Motor Override (CMO) – Open/Close during Power Outage
- 4-In-1 Group Control – Connect 4 motors to open/close simultaneously, daisy chain Group Controls to open/close more than 4 operators

Width Back of Guide

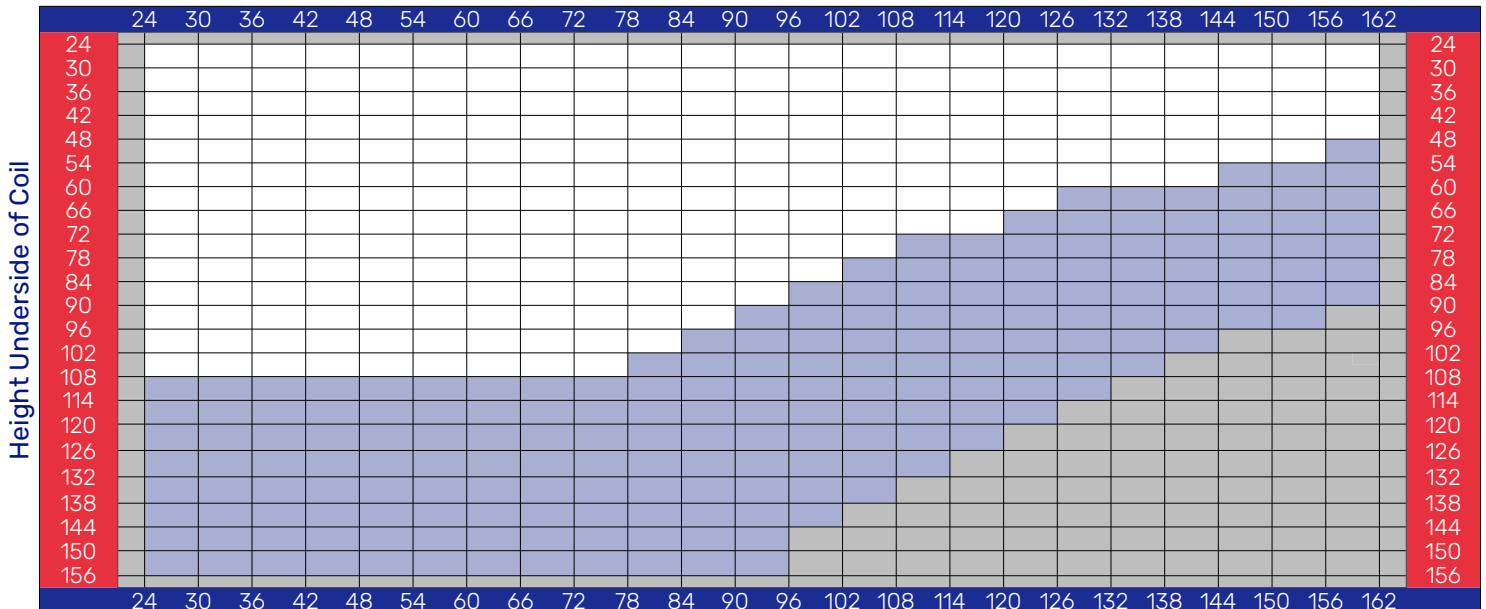

Manual Push/Pull, Crank, Electric Operator



Electric Operator



Not Available