

### 1 Curtain Details

Slat 2.17 in. [55mm] Roll Formed, Foam Filled Aluminum Slat

#### Color Options

-  Metallic Paint
-  Dark Bronze Paint
-  Beige Paint
-  White Paint

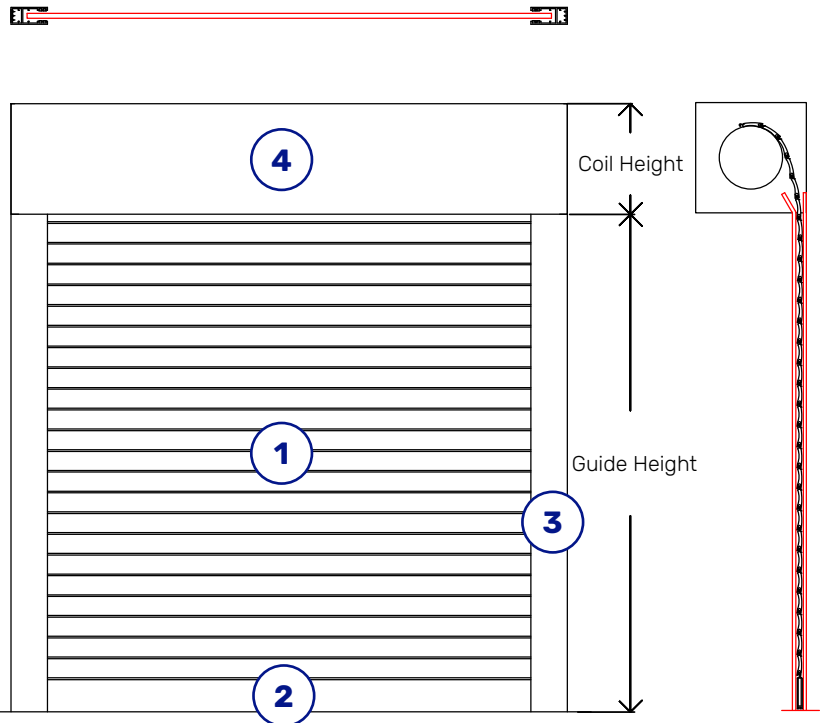
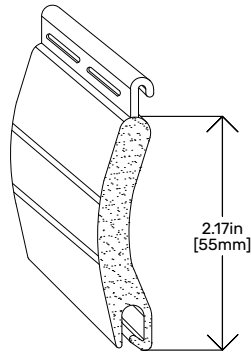

### 2 Bottom Bar

Bottom Bar

HD Bottom Bar (Optional)

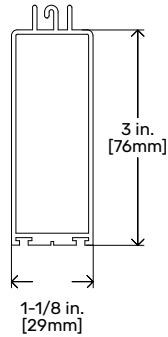
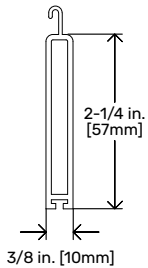

### 3 Guide Options

Guide Rail

HD Guide Rail (Optional)

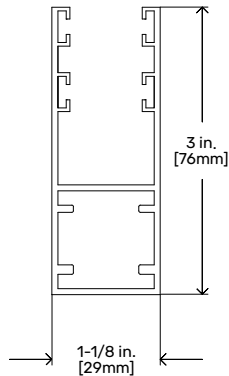
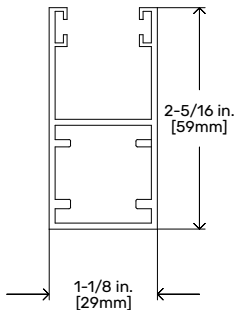

### 4 Coil Box Size

Coil Height	Guide Height
7 in. [178mm]	30 in. [762mm]
8 in. [203mm]	60 in. [1524mm]
9 in. [229mm]	82 in. [2083mm]
10 in. [254mm]	103 in. [2616mm]
11 in. [279mm]	128 in. [3251mm]

# Features And Options

## Mounting Type

Between Jamb

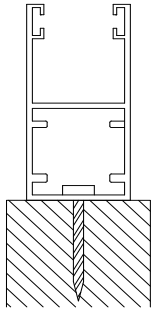

Face Of Wall

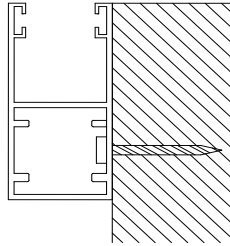

## Locking Bottom Bar Options

- Locking Coil side or Opposite Coil with Slide Lock or Cylinder.
- Heavy Duty Bottom Bar with Standard Mortise, SFIC, LFIC or Thumbturn



LFIC



SFIC



StdMortise



Thumbturn



Standard Mortise Cylinder Key Switch

## Operation

### Manual Push/Pull

- Counterbalance with Spring Assist for easy manual operation
- Available with locking bottom Bar (Slide lock or Cylinder Locks)

### Crank Operation

- Crank Operation Coil Side or Thru-Wall
- Available with locking bottom Bar (Slide lock or Cylinder Locks)

### Electric Operation

- Electric Motor Operation
- Push Button or Key Cylinder Switch for easy up/down

## Motor Options

- Key Switch – Open/Close using Standard Mortise, SFIC
- RTS – Wireless Open/Close using Telis remote
- Crank Motor Override (CMO) – Open/Close during Power Outage
- 4-In-1 Group Control – Connect 4 motors to open/close simultaneously, daisy chain Group Controls to open/close more than 4 operators

## Width Back of Guide

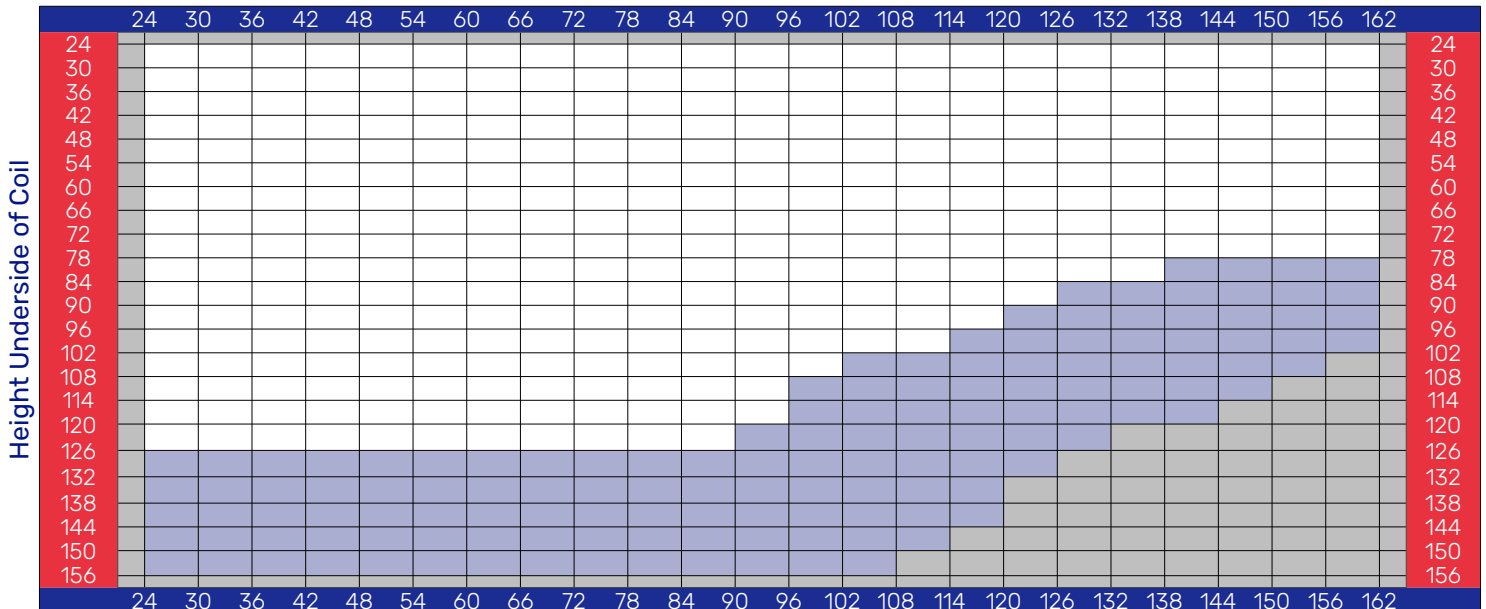

Manual Push/Pull, Crank, Electric Operator



Electric Operator



Not Available